

Independence Park

RENOVATION PLAN

HLC REVIEW



A teal-tinted photograph of a park scene. In the foreground, a large sandpit is filled with children playing. To the left, there is a stone gazebo with a peaked roof. The background is filled with tall trees and more people walking or sitting on the grass. The overall atmosphere is peaceful and recreational.

Project Context

Park Evolution

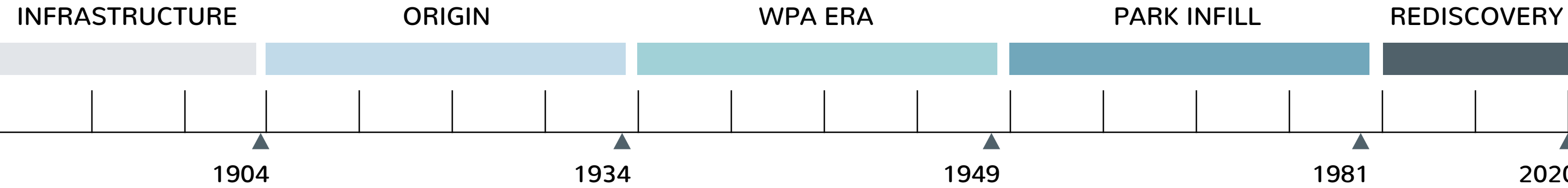

LATE 1800s - 1904



1906 NOLEN PLAN



1934 - 1949

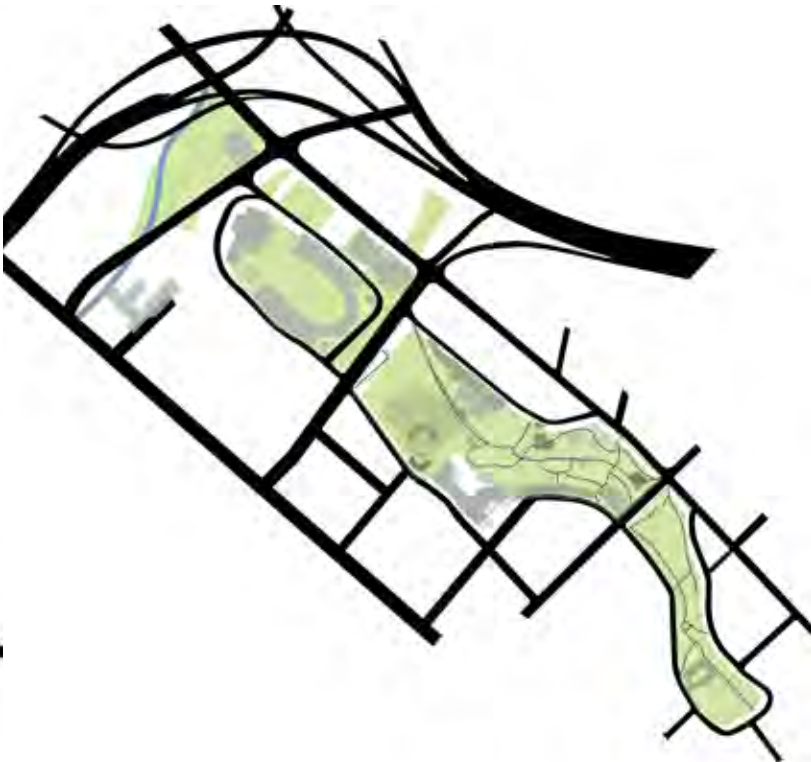

1949 - PRESENT

Character

ONE PARK, MANY ZONES

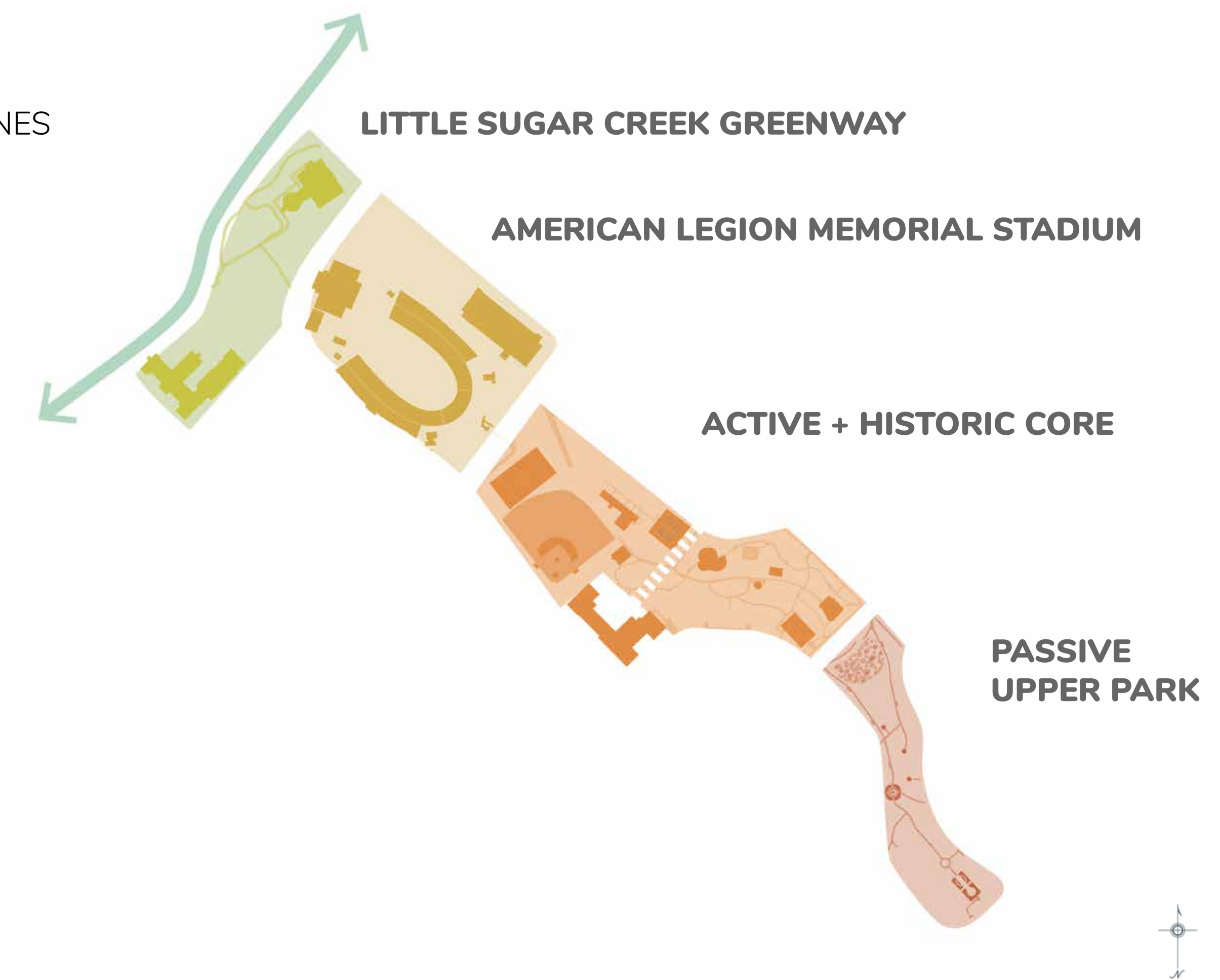

A teal-tinted photograph of a park scene. In the foreground, a large, irregularly shaped sand area is where several people, including children and adults, are playing. Some are sitting on the sand, while others are standing or moving. In the background, there is a stone gazebo with a peaked roof and several tall, leafy trees. The overall atmosphere is peaceful and recreational.

Design Update

Big Moves

THE PARK TODAY

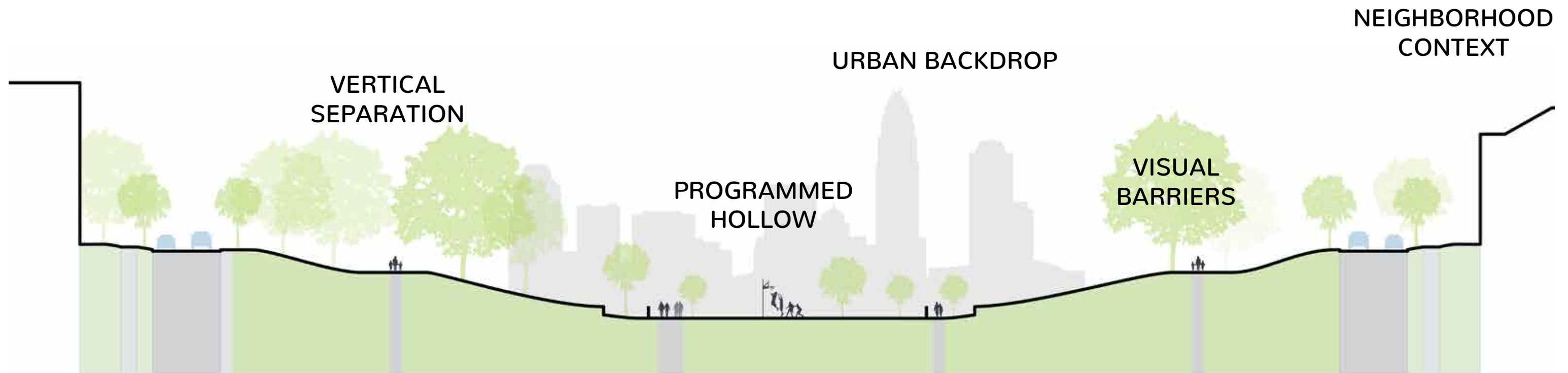

Big Moves

CHARACTER AND HISTORY

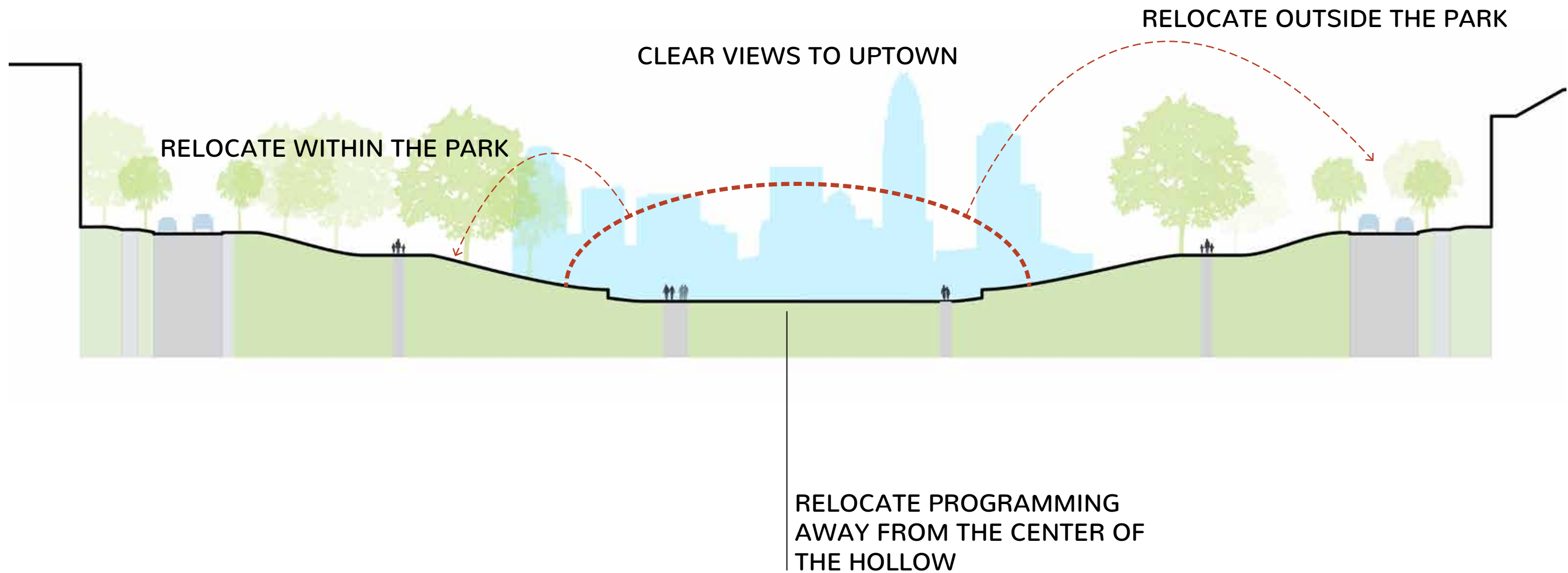

Big Moves

ACCESS

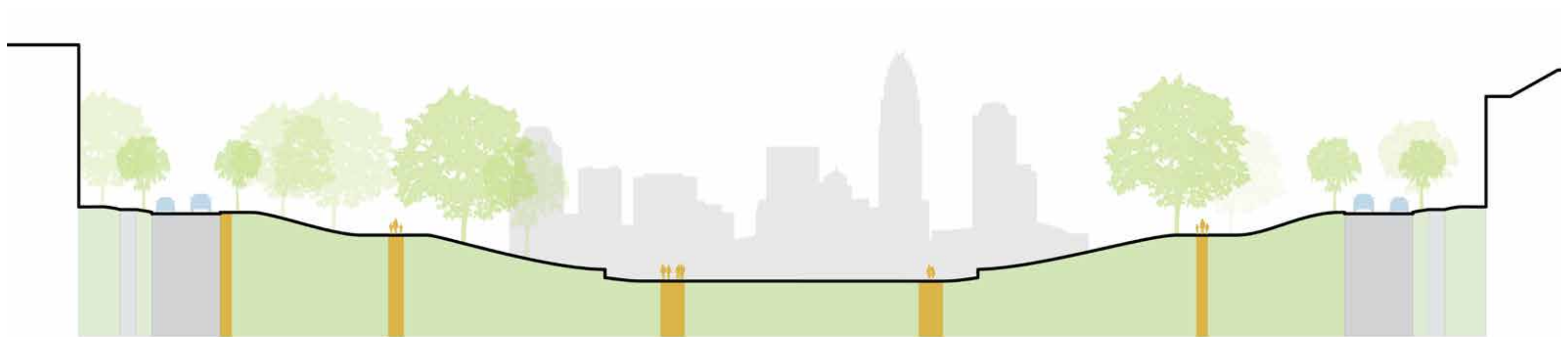

PROVIDE BEAUTIFUL AND
ACCESSIBLE ENTRIES

CREATE INTERNAL LOOPS AT
THE HOLLOW ELEVATION

PROVIDE ACCESSIBLE
MID-SLOPE PATHS INTO
THE PARK

Big Moves

ACTIVITIES

CREATE COMMUNITY-SCALE
PROGRAM AREAS AROUND THE
PERIMETER OF THE MAIN LOOPS

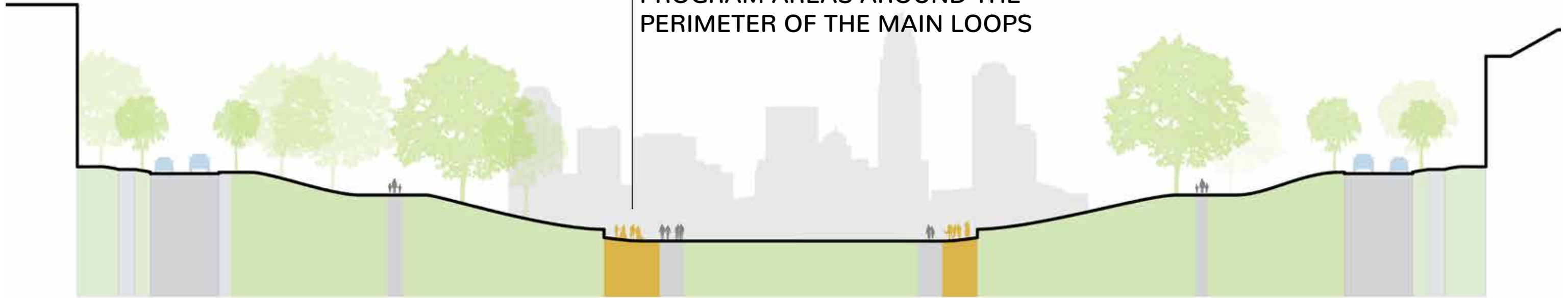

Big Moves

NATURE

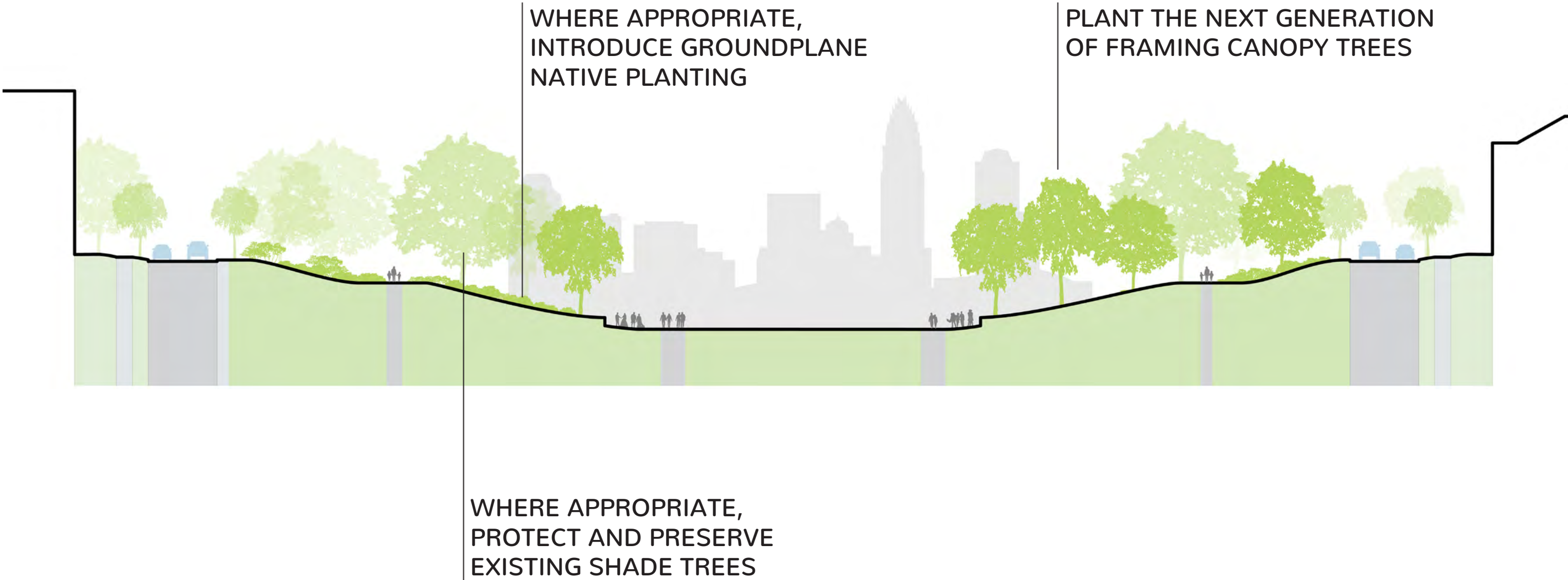

Big Moves

STORMWATER

CREATE STORMWATER LANDSCAPES TO
HOLD AND FILTER RUNOFF BEFORE IT
REACHES THE MAIN CULVERT

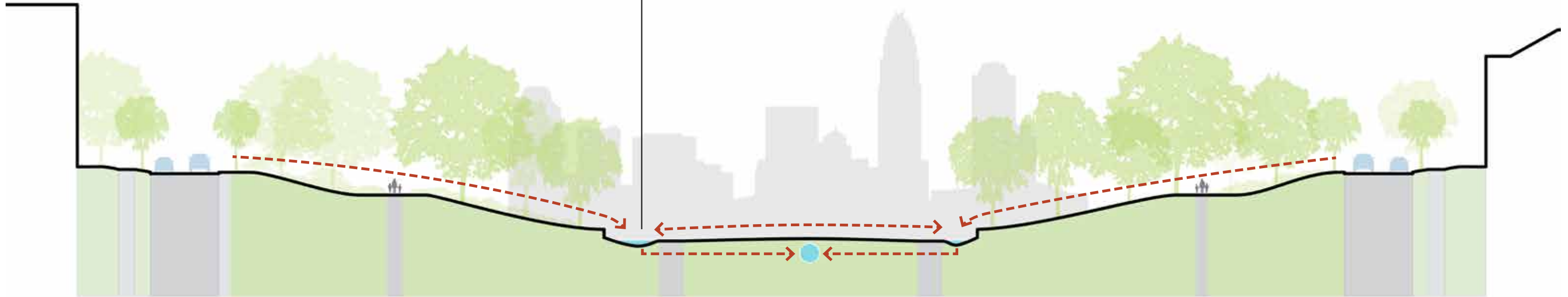

The Park Today

EXISTING SITE



The Renovation Plan

PROPOSED SITE PLAN



The Renovation Plan



Relocate the active recreation facilities (playground, volleyball, table tennis and basketball) to the periphery to reestablish the Hollow contained in Nolan's original plan.

Add a public restroom building with an overlook on the roof.

Create a continuous path system that includes an accessible paths into the park at Seventh Street and Hawthorne Lane from the Armory building parking lot into the Hollow at the new restroom.

Preserve existing shade trees and reestablish the shade tree border around the periphery.

The Renovation Plan

Remove the steps at the intersection of Hawthorne Ave and Seventh Street and replace them with an accessible path.(monument to be relocated within the park).

Added accessible path (that does not require handrails) around the eastern edge of the park allows for removal of the existing path/handrails between the walls and the rose garden entrance.

Reduce the size of the parking lot.

Reestablish a shade tree periphery and a restore the camellia/azalea garden.

The nature play area offers children's play structures in this portion of the park.



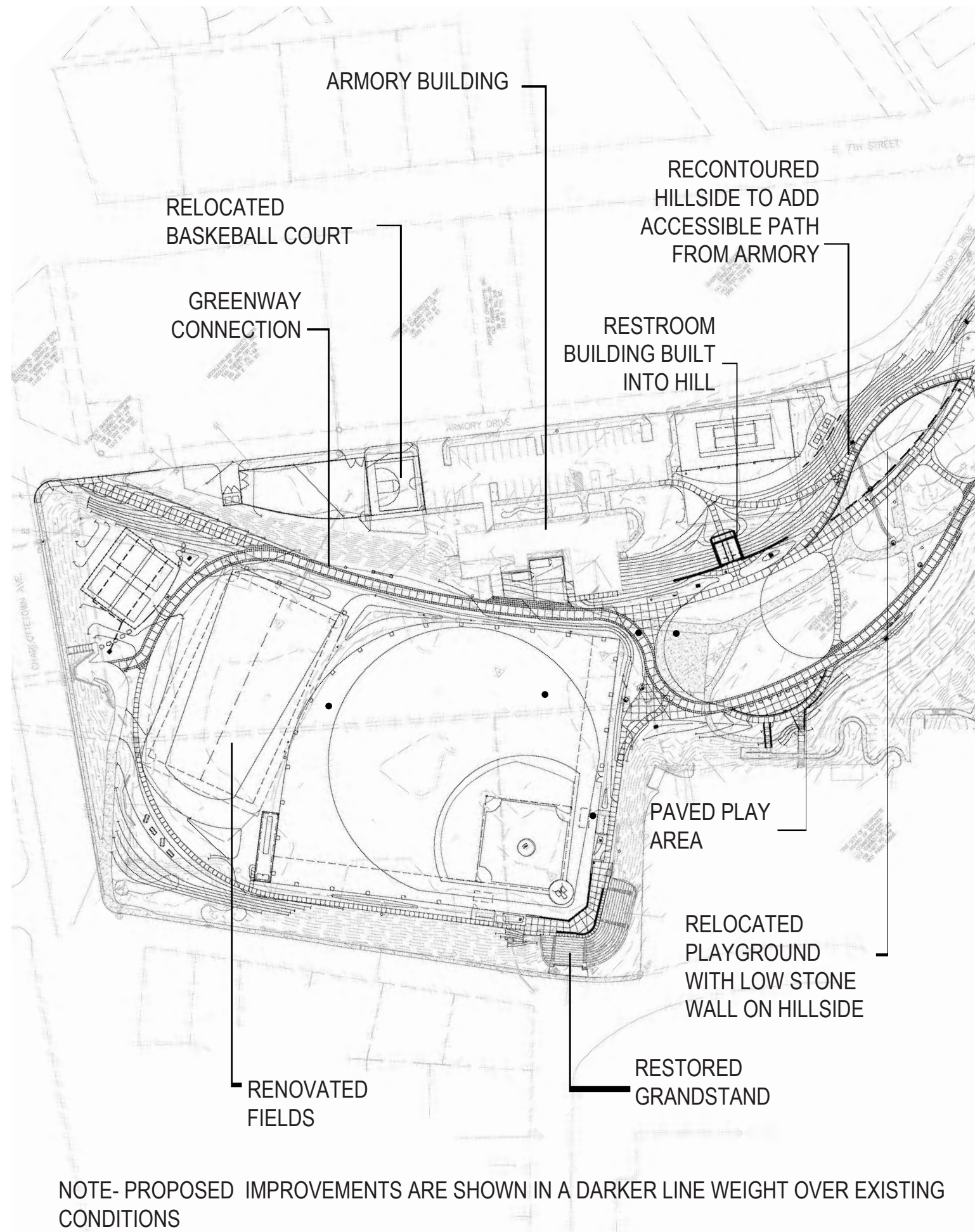

VIEW OF THE EXISTING PLAYGROUND WHICH WILL BE NESTLED INTO THE RECONTOURED HILLSIDE TO OPEN THE HOLLOW. FOREGROUND IS THE LOCATION OF THE NEW RESTROOM BUILDING.



VIEW OF THE SCHOOL. THIS AREA WILL INCLUDE A NEW PAVED PLAY AREA WITH A BASKETBALL GOAL. IT WILL BE ADJACENT TO THE GREENWAY BUT SEPARATED BY BOULDERS. THE EXISTING BASKETBALL COURT IS RELOCATED ADJACENT TO THE ARMORY PARKING.

Armory Restroom and Overlook



Lower Restroom

April 6, 2020

Armory Restroom and Overlook



Upper Side

April 6, 2020

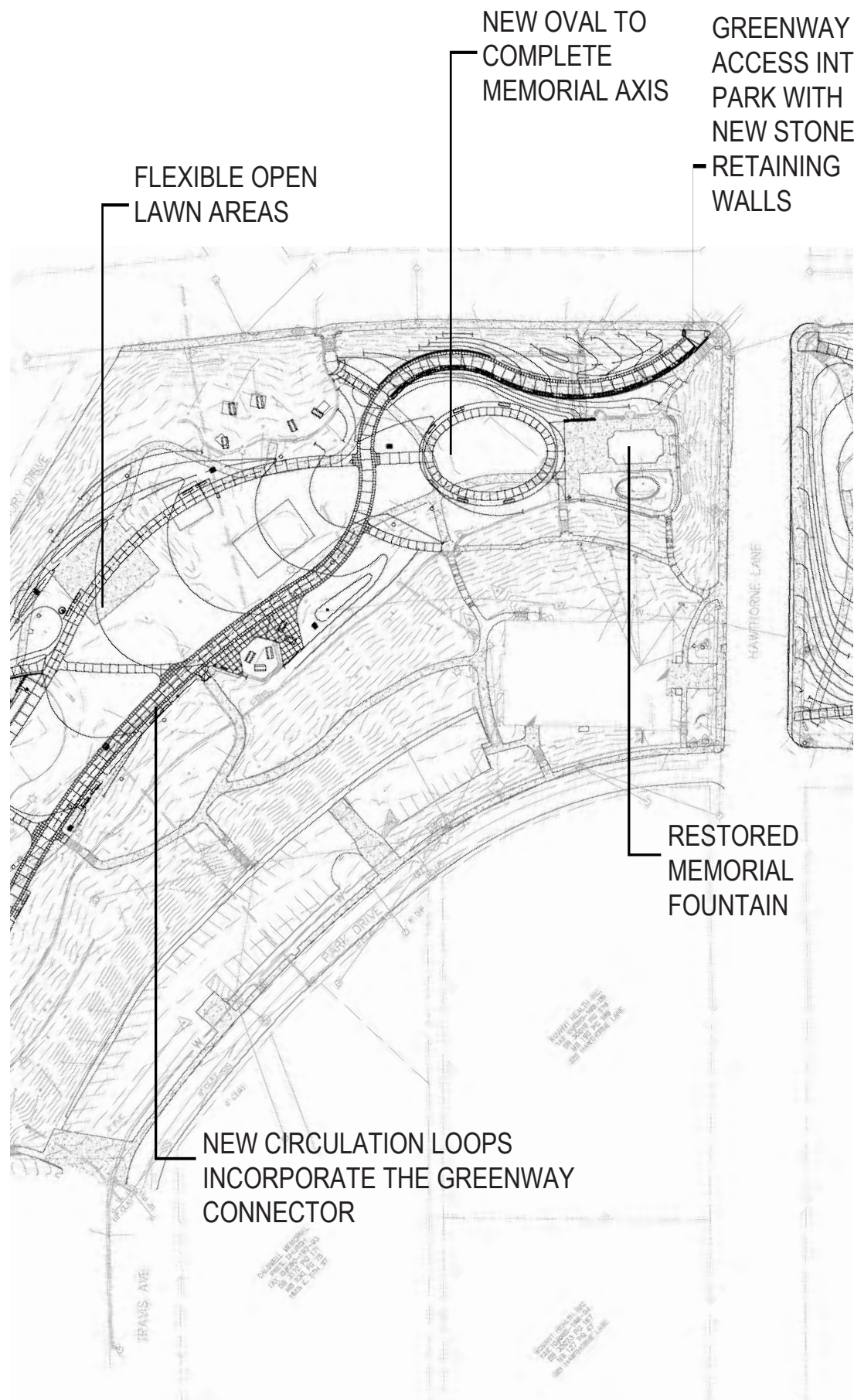

VIEW OF STONE PAVILION ON AXIS WITH THE MEMORIAL FOUNTAIN (BEYOND)



EXISTING PAVEMENT CONDITIONS



VIEW OF AREA WHERE NEW GREENWAY ACCESS FROM HAWTHORNE LANE WILL BE LOCATED



EXISTING STAIRS TO REMAIN, NEW GREENWAY ACCESS TO BUILT BESIDE THE STAIRS

Existing Arhelger Memorial

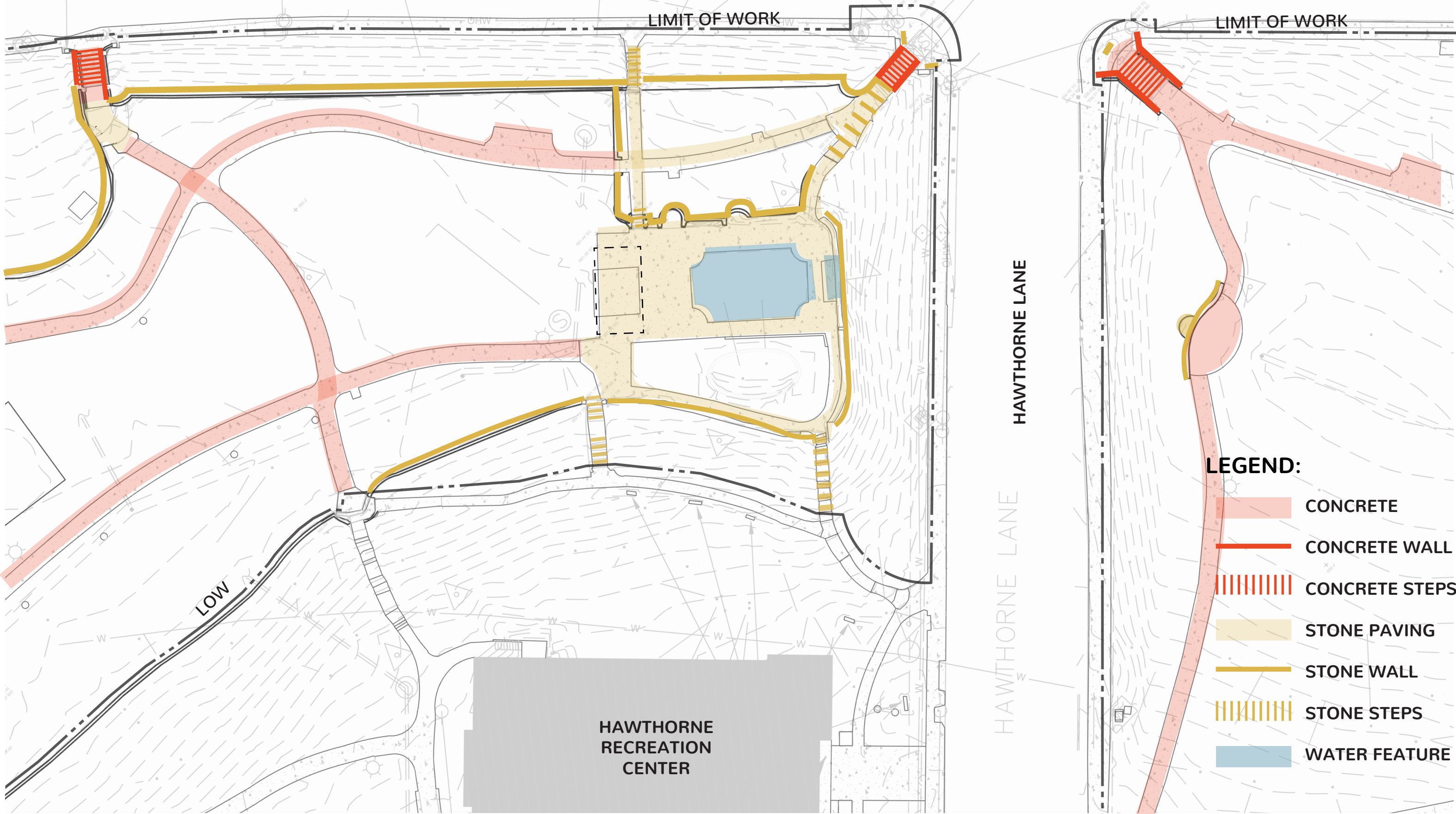

Proposed Arhelger: Preserved

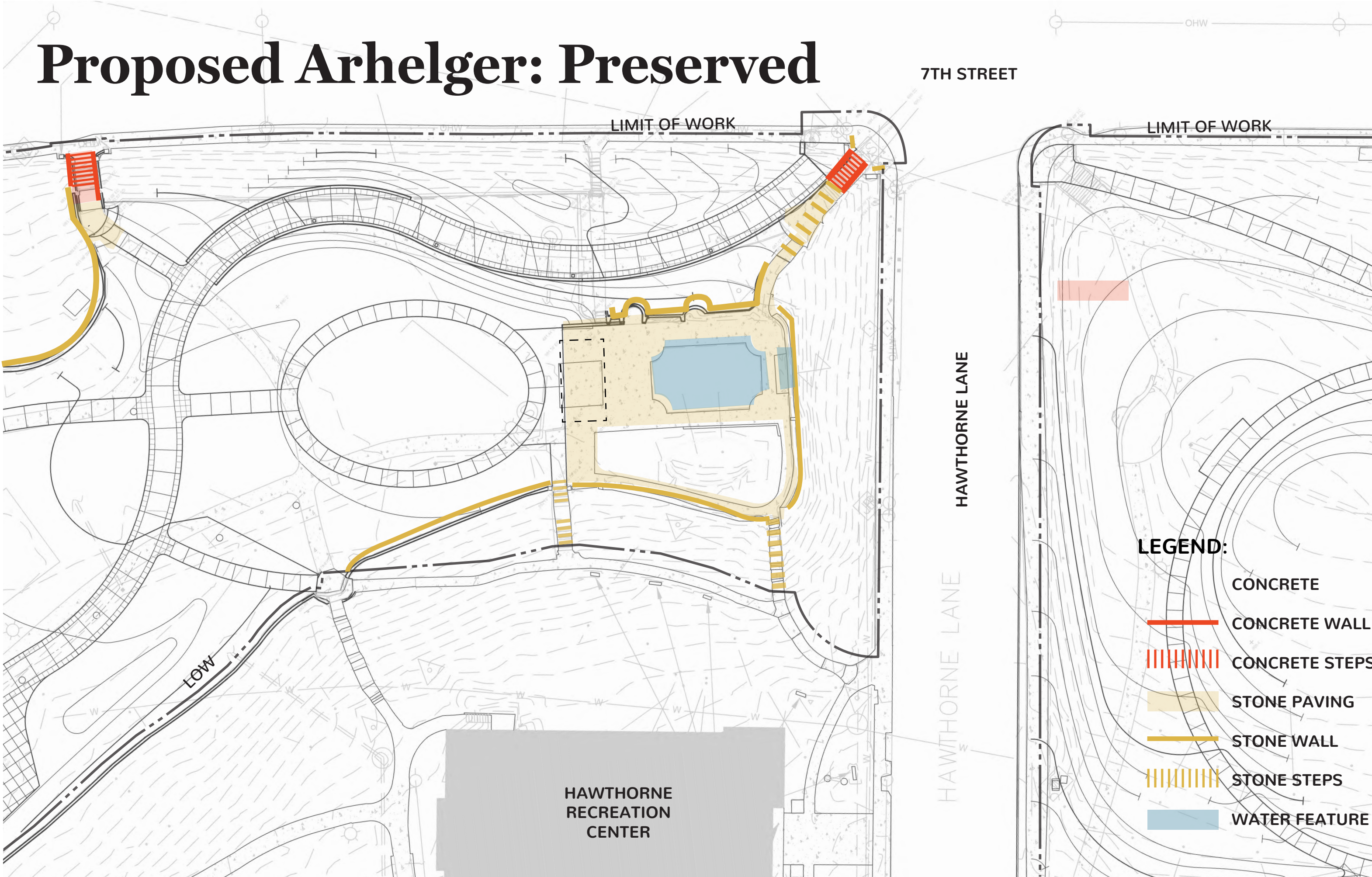

Proposed Arhelger Memorial

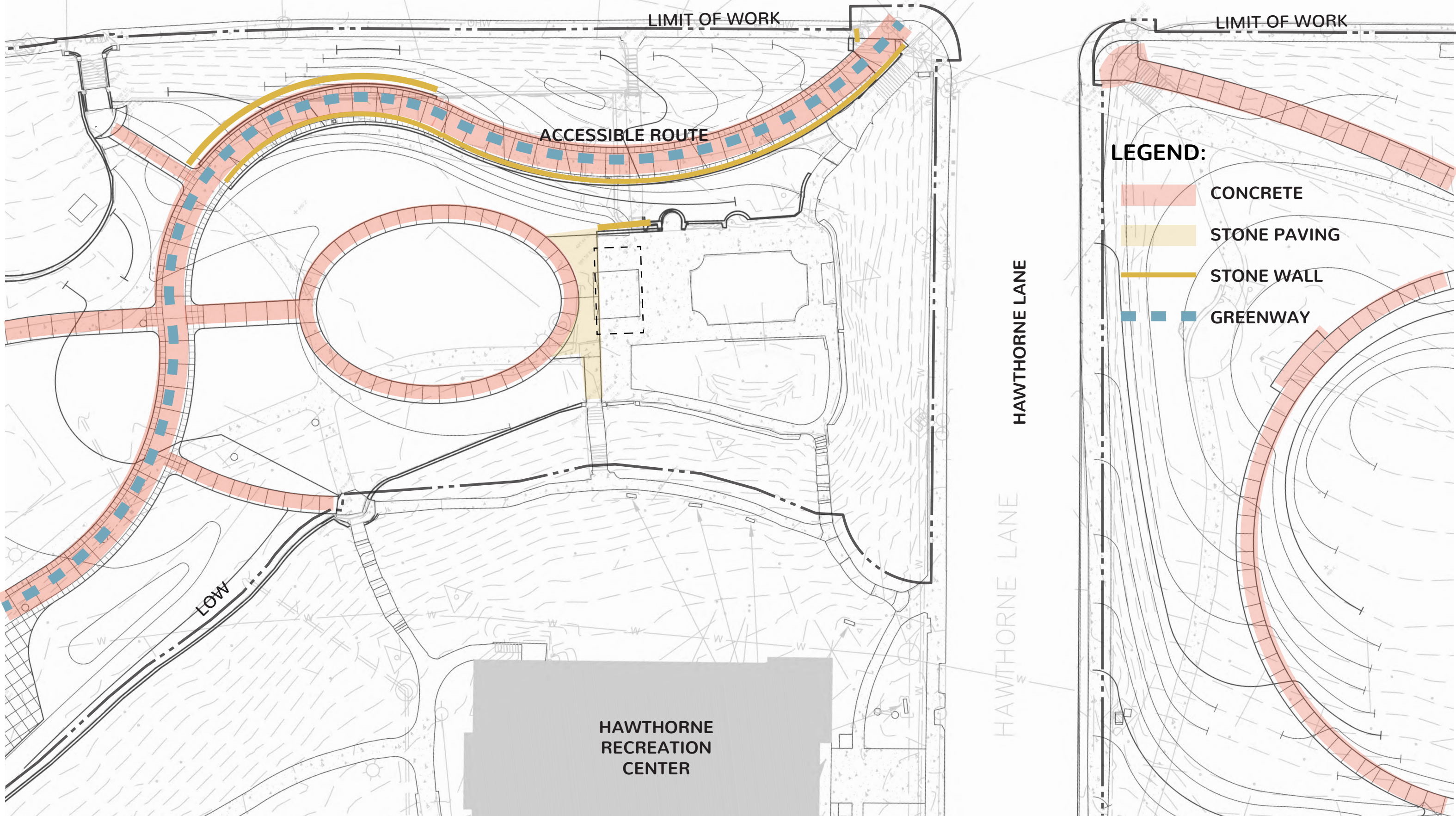

ACCESSIBLE PATHS AT THE INTERSECTIONS OF HAWTHORNE LANE AND SEVENTH ST. AND AT PARK DRIVE.

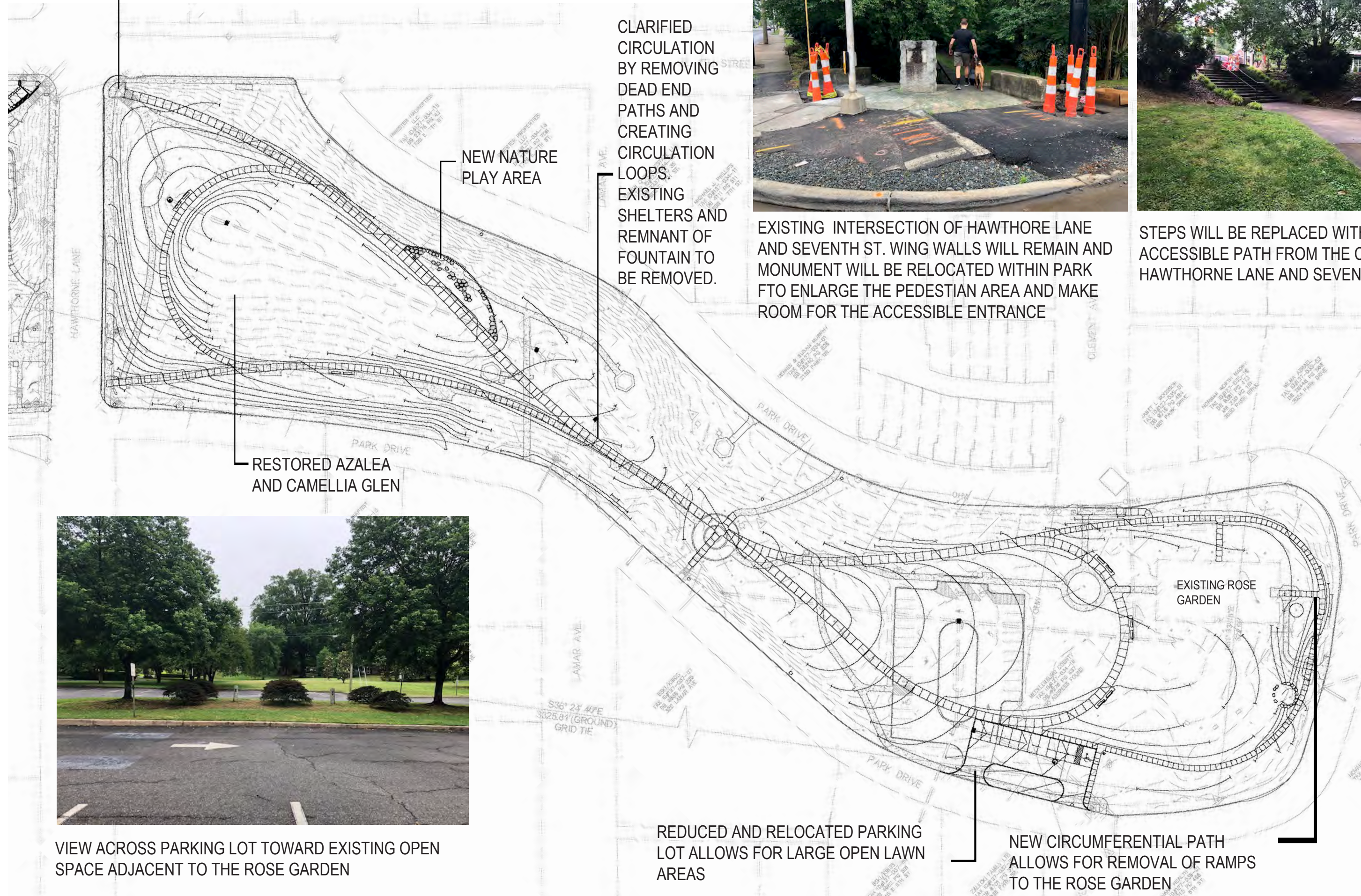

CLARIFIED CIRCULATION BY REMOVING DEAD END PATHS AND CREATING CIRCULATION LOOPS. EXISTING SHELTERS AND REMNANT OF FOUNTAIN TO BE REMOVED.



EXISTING INTERSECTION OF HAWTHORE LANE AND SEVENTH ST. WING WALLS WILL REMAIN AND MONUMENT WILL BE RELOCATED WITHIN PARK FTO ENLARGE THE PEDESTIAN AREA AND MAKE ROOM FOR THE ACCESSIBLE ENTRANCE



STEPS WILL BE REPLACED WITH AN ACCESSIBLE PATH FROM THE CORNER OF HAWTHORNE LANE AND SEVENTH STREET

REDUCED AND RELOCATED PARKING LOT ALLOWS FOR LARGE OPEN LAWN AREAS

NEW CIRCUMFERENTIAL PATH ALLOWS FOR REMOVAL OF RAMPS TO THE ROSE GARDEN



VIEW ACROSS PARKING LOT TOWARD EXISTING OPEN SPACE ADJACENT TO THE ROSE GARDEN